



Fendt 700

OEM Front 3-Point Hitch Support Installation Instructions

For Models:

Fendt 700 Vario Gen 7:

720, 722, 724, 726, 728

Purchase Date
Serial Number
Model Number
Tractor Model
Dealer

To The Owner

This manual contains information concerning the installation of the front support. You have purchased dependable, long lasting equipment, but only by proper care and operation can you expect to receive the performance and long service built into our products. Please have all operators read this manual carefully and keep the manual available for ready reference. If you have any questions or concerns, contact Grouser Products.

Caution:

- Always use caution when working around any equipment.
- Always wear safety glasses.
- Follow tractor manufacturer's safety guidelines when installing this product.
- Use paint where necessary to prevent rust.
- Do not modify or permit anyone else to modify or alter the equipment and its components without first consulting Grouser Products.



Serial Number Location

Note:

- When installing hardware, only finger tighten until all hardware is in place.
- A full diagram of the assembly with the full list of parts is on pages 8-9.
- Unstrap and remove any components that are attached for shipping.
- Read all instructions prior to performing installation.



To ensure the safety of those working under and around the machine, apply parking brake, remove key from ignition, and block tires before working on the machine.

Pre-Installation

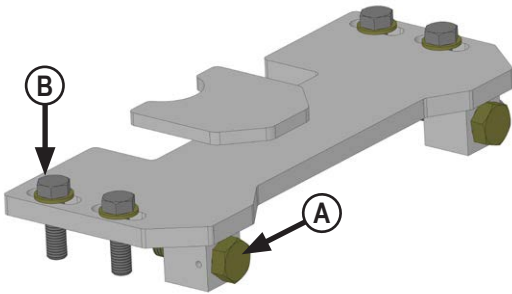

1. Complete thread 2 - 1" x 3" bolts into threaded blocks on push bracket (A). The bolts will be adjusted in Step #10.
2. Place 4 - 3/4" x 2-1/2" bolts and 4 - 3/4" flat hardened flat washers through slots on push bracket (B).

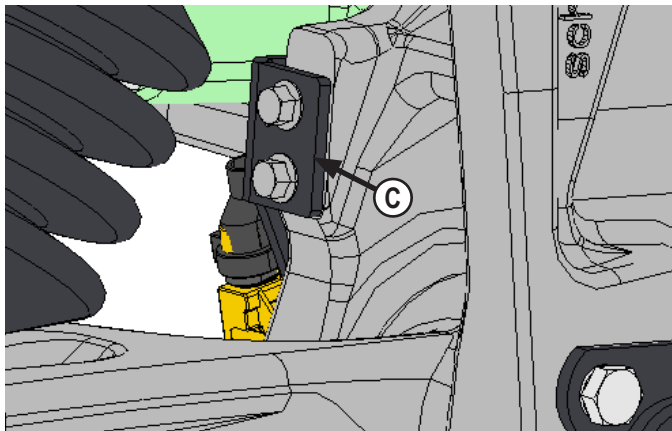

3. Remove flange bolts from original sensor bracket (C).
4. Temporarily place sensor out of way to install front support.

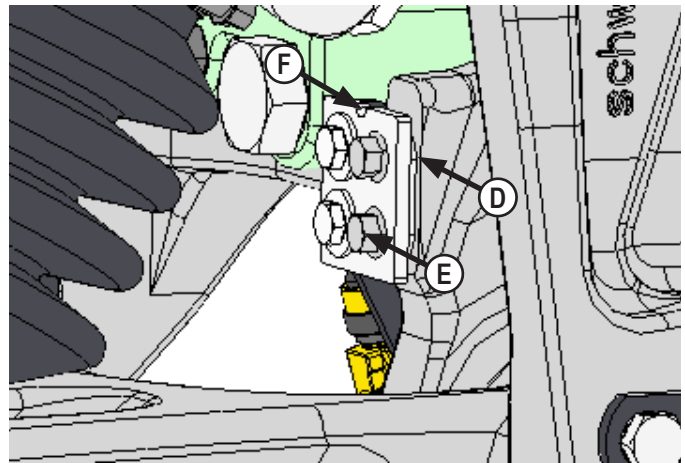

5. Install new spacer (D) and relocation plate with original flange bolts (E).

NOTE: Relocation plate needs to be positioned with notch facing upward (F).

Installation

1. Center front support under tractor.
2. Support front lifting arms and remove retaining hardware and pins attaching front lifting arms to tractor.



Caution: When lifting front and rear support, watch for potential pinching of hoses or other components to prevent any damage.

3. Raise front support until support ears line up with tractor frame ears and front lifting arms.

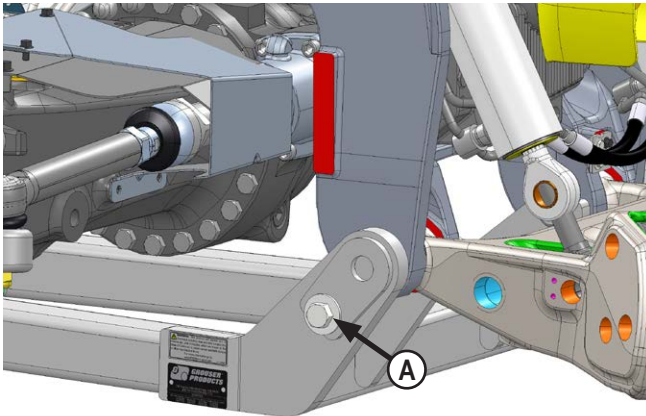

4. Install 2 new pins and secure with 2 - 3/4" x 2-1/2" bolts, 2 - 3/4" flat washers, 2 - spacers and 2 - 3/4" nuts (A).

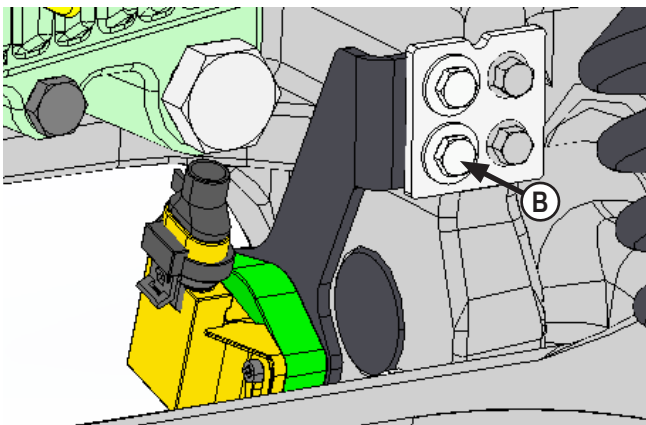

5. Attach sensor bracket to new relocation bracket with 2 - 1/4" x 3/4" bolts, 4 - 1/4" flat washers and 2 - 1/4" nuts (B).

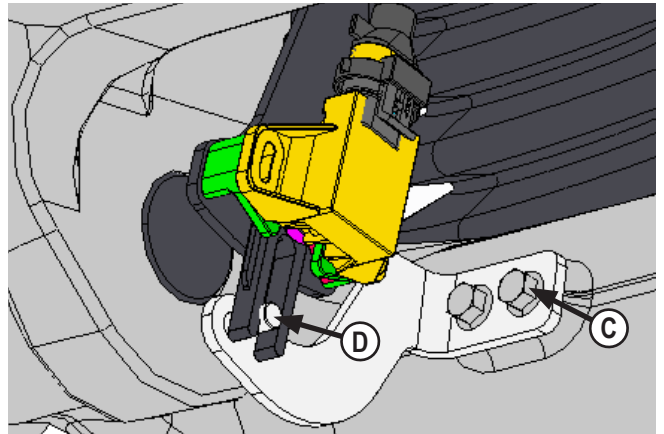

6. Replace original sensor actuator bracket with new sensor actuator bracket. Attach with original hardware (C).

NOTE: Verify pin is engaged in slot (D).

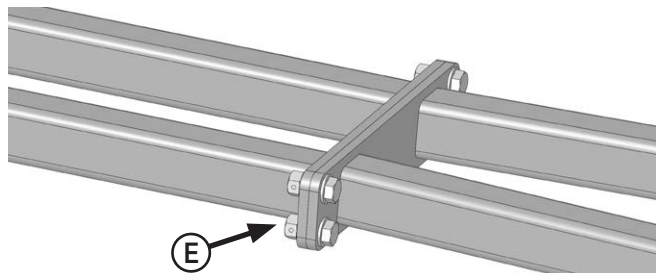

7. Raise rear support frame and attach front support frame to rear support frame with 4 - 3/4" x 2" bolts, 8 - 3/4" hardened washers and 4 - 3/4" nuts (E).

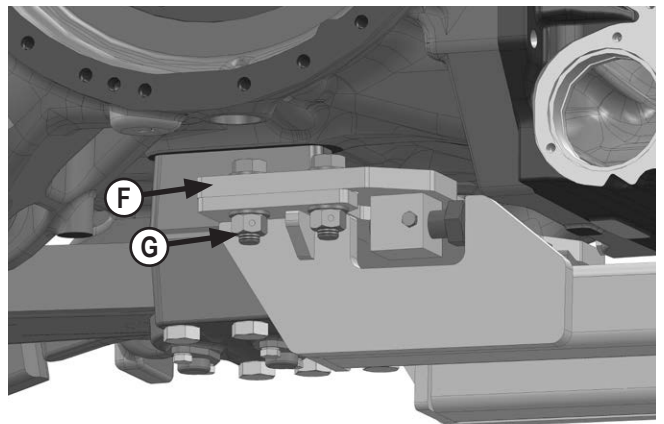

8. If necessary to make room to install rear support and push bracket, remove drawbar pin and drawbar.
9. Set push bracket with preinstalled hardware from Page 1 on rear drawbar bracket (F). Raise rear support frame and attach to push bracket with 4 - 3/4" hardened washers and 4 - 3/4" nuts (G).
10. Torque front 3/4" bolts (A) to 257 ft-lbs.
11. Torque middle 3/4" bolts (E) to 257 ft-lbs.

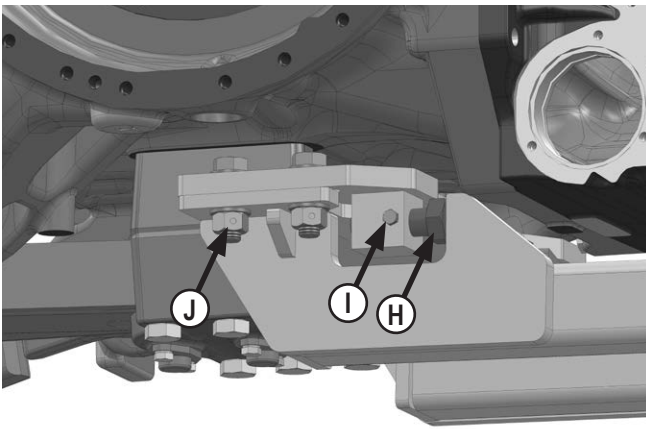

12. If necessary, remove radar to gain access to 1" bolts. Reinstall after rear push bracket is installed completely.
13. Evenly unscrew 1" bolts (**H**) on push bracket until pushing on rear of rear support frame and push bracket is pushing evenly against drawbar support bracket.. Torque 1" bolts to 90-95 ft-lbs.
14. Install 2 - 5/16" x 3/4" bolts into blocks on push bracket to lock 1" bolt (**I**).. Torque 5/16" bolts to 19 ft-lbs.
15. Torque rear 3/4" bolts (**J**) to 257 ft-lbs.
16. If necessary, reinstall drawbar.
17. **Check the steering clearance at front support ears.** The minimum clearance between front support pin and tire should be about 1". If necessary, purchase steering stops from your local dealership.

NOTE: Sensor calibration is necessary after relocating the sensor. Follow the calibration steps on Pages 5-7.

Maintenance

1. After first 8 hours of use, re-torque all bolts.
2. Check all fasteners regularly to ensure proper operation of equipment.
3. Inspect all equipment for existing or potential damages every 10 hours or less.

Sensor Calibration

FENDT

0000 - Tractor
F - Settings and calibration

If calibration is completed without errors, **O.K.** appears and the new sensor settings are saved.

NOTE: Settings are only stored when ignition key has been turned to "0" position.

(Wait for at least 15 seconds before switching the ignition on again!)

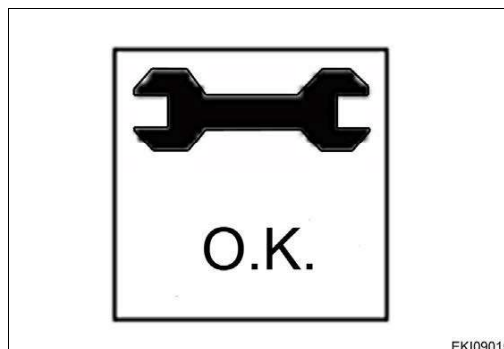

Fig. 42.

EKI09015
I003578

If incorrect values are detected or the conditions are not met, an **ERROR** message appears

9001 = calibration code

FXX = error code (see table)

NOTE: See also:

*** 'Fault code for calibration code 9001' on page 144 ***



Fig. 43.

EKI09024
I003593

Calibrating the front power lift position (code 9002)

Important: The following preparatory steps must be carried out

- Hand brake applied
- Start engine.
- If fault messages are displayed, the faults must be confirmed one by one.



Press "ESC" to confirm the warning and fault messages displayed on the A007 instrument panel

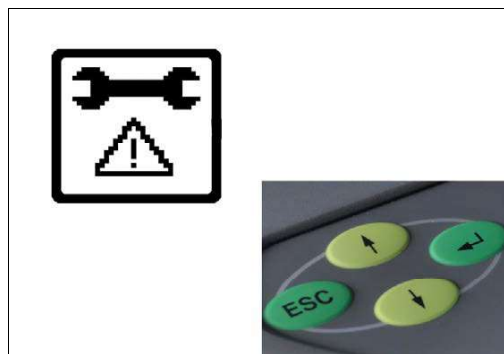
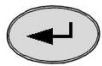

Fig. 44.

I029265



Press "Return" and the first main menu appears in the multiple display



Press one of the buttons repeatedly until the symbol (A) flashes

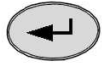

Press "Return", the second main menu appears in the multiple display

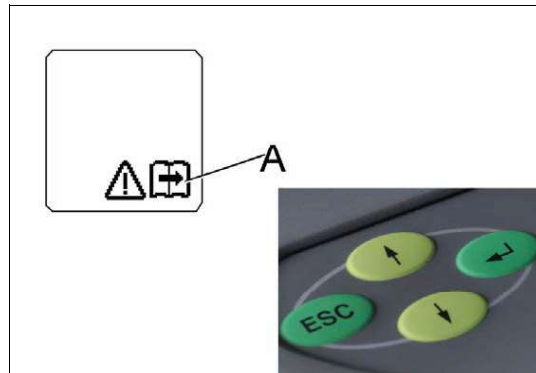

Fig. 45.

I029138

The second main menu appears in the multiple display



Press one of the buttons repeatedly until the symbol (A) flashes

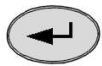

Press "Return" to confirm

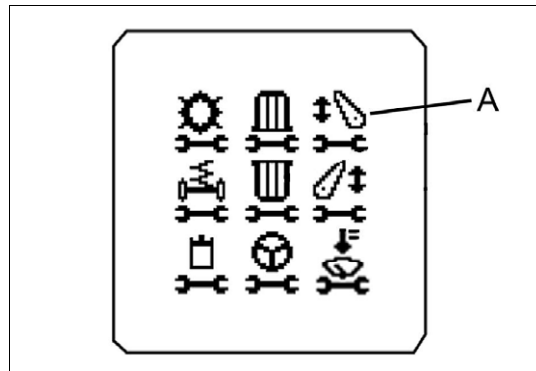

Fig. 46.

I046136

The front power lift menu appears in the multiple display



Press one of the buttons repeatedly until the symbol (A) flashes

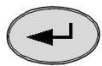

Press "Return" to confirm

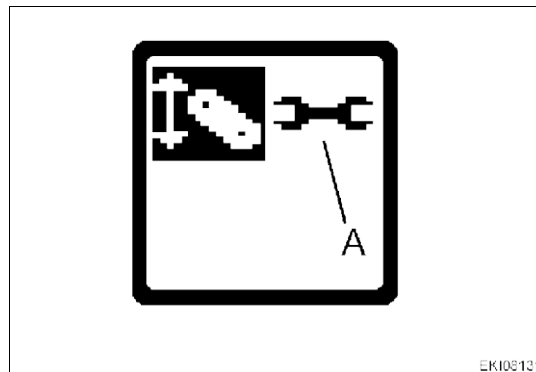

Fig. 47.

EKI05131
I000911

Input code **9002**



Press one of the buttons until desired number is displayed

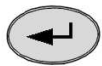

Press "Return" to confirm

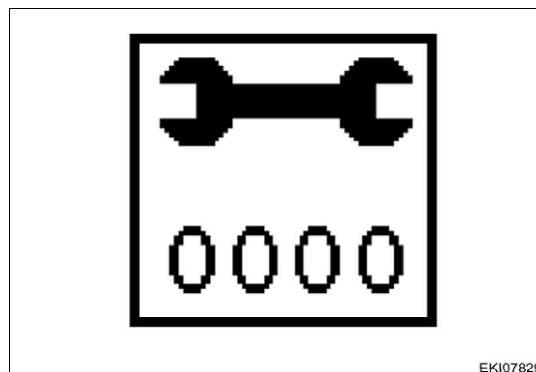

Fig. 48.

EKI07829
I000773

Turn quick lift switch to "raise". The front power lift is raised and remains in the top position

Press "Return" to confirm

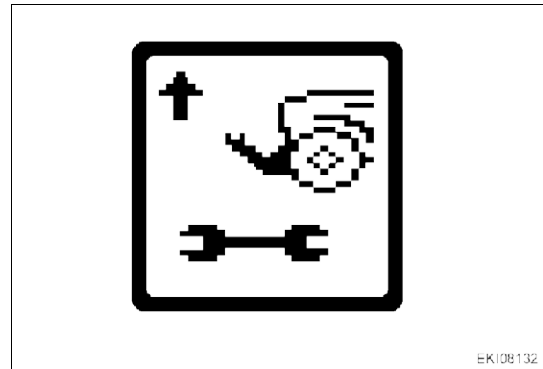

Fig. 49.

EK108132
 I000918

Set quick lift switch to "lower". The front power lift is lowered and remains in the bottom position

Press "Return" to confirm

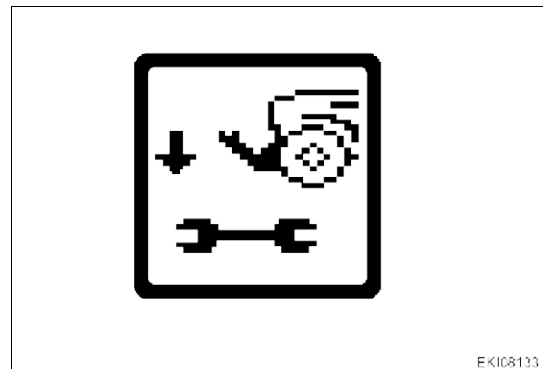

Fig. 50.

EK108133
 I000919

If calibration is completed without errors, **O.K.** appears and the new sensor settings are saved.

NOTE: Settings are only stored when ignition key has been turned to "0" position.
 (Wait for at least 15 seconds before switching the ignition on again!)

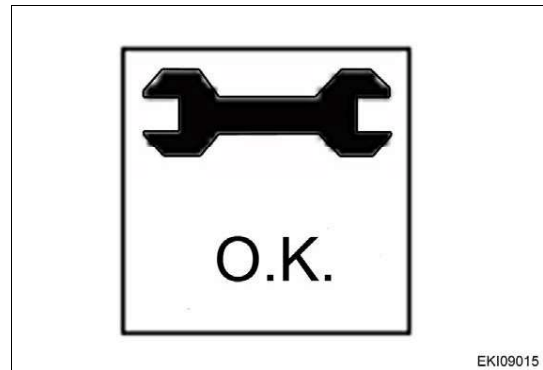

Fig. 51.

EK109015
 I003578

If incorrect values are detected or the conditions are not met, an **ERROR** message appears

9002 = calibration code

FXX = error code (see table)

NOTE: See also:

*** 'Fault code for calibration code 9002' on page 144 ***

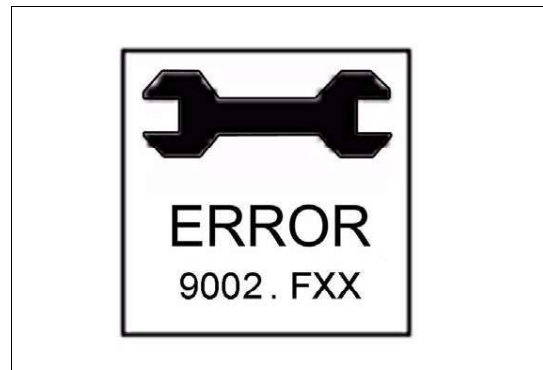
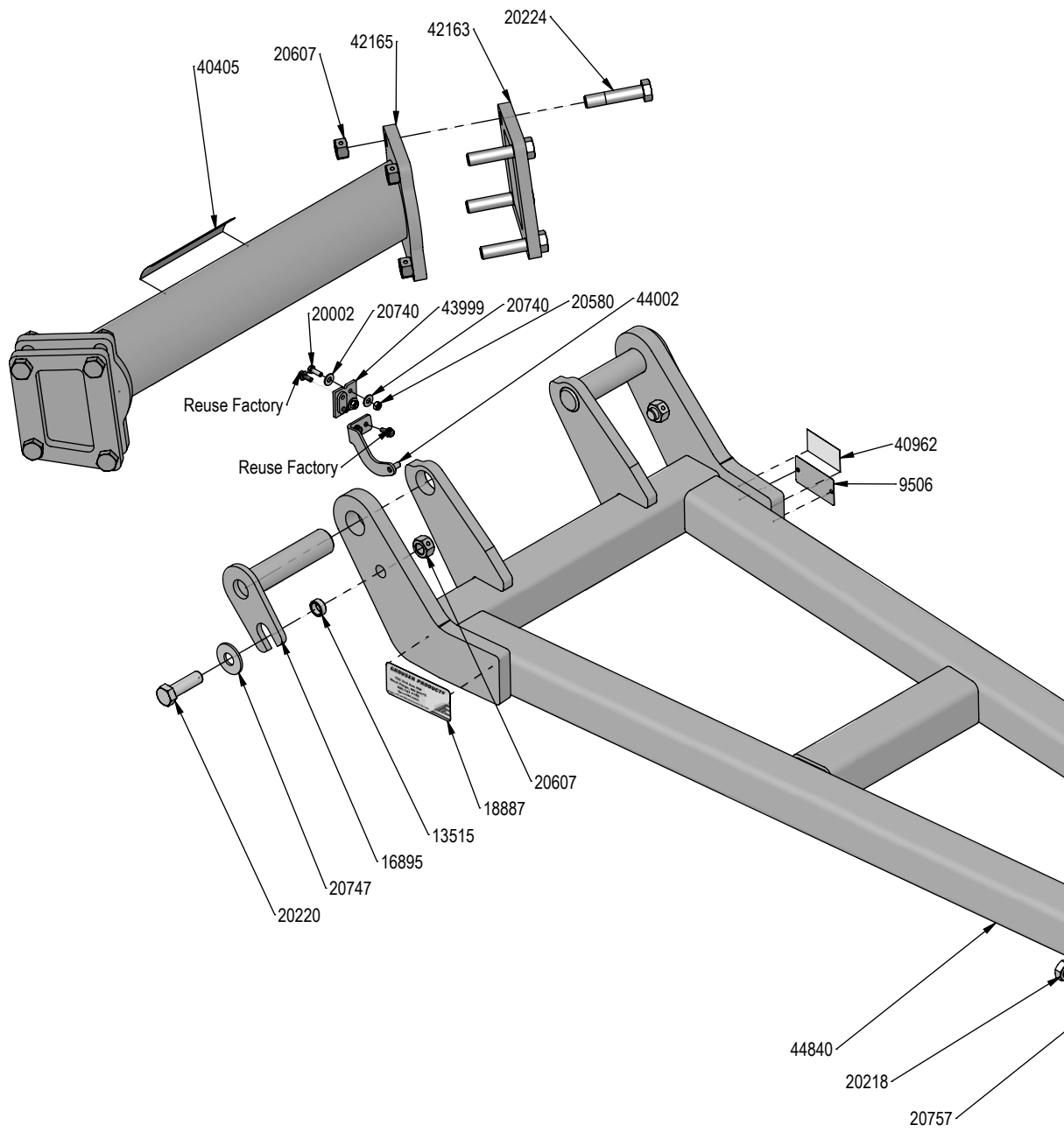
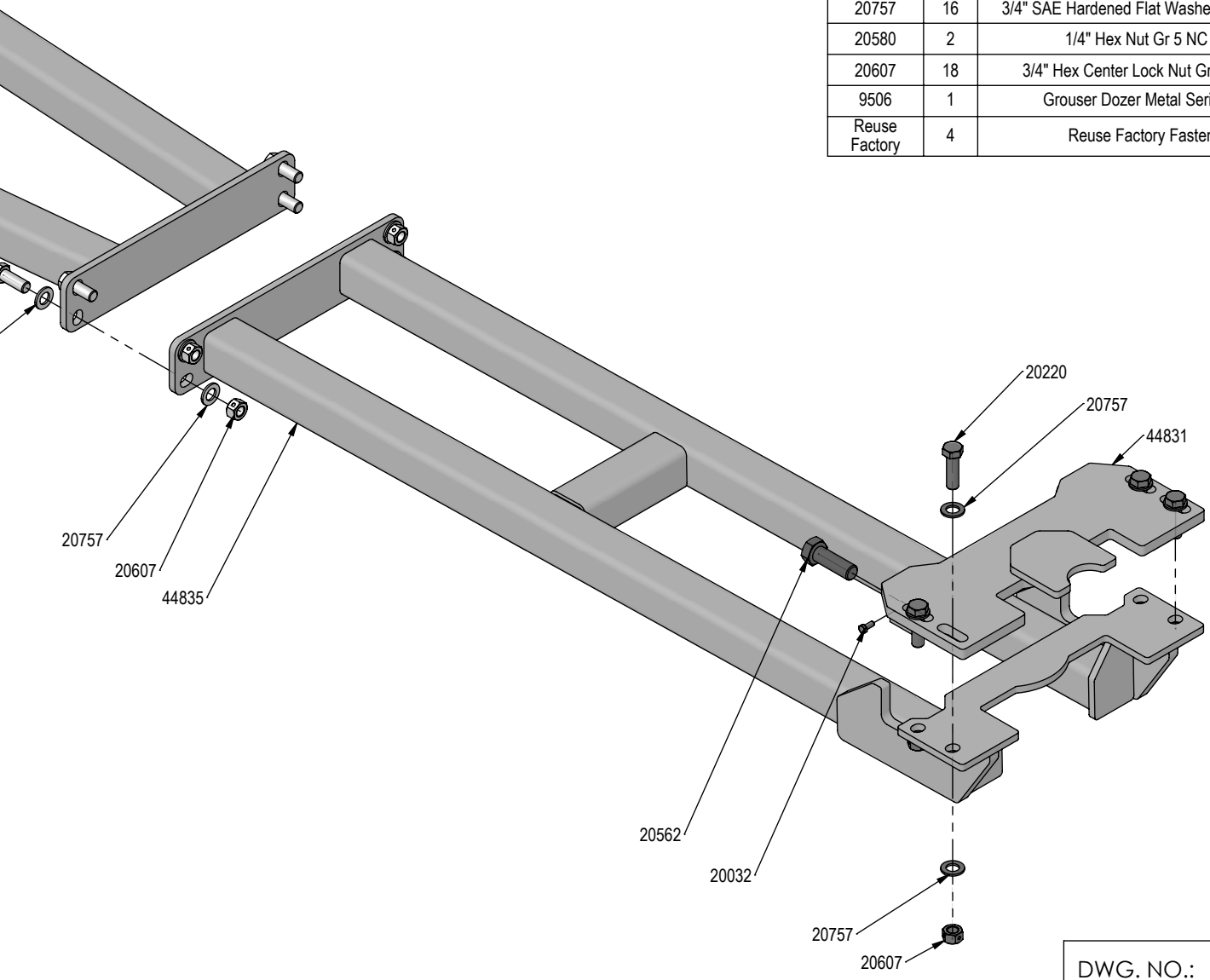

Fig. 52.

I053228



PART NO.	QTY.	DESCRIPTION
42165	1	Torque Arm
20002	2	1/4" X 3/4" Hex Bolt Gr 5 NC CZ
20032	2	5/16" X 3/4" Hex Bolt Gr 5 NC CZ
20218	4	3/4" X 2" Hex Bolt Gr 5 NC CZ
20220	6	3/4" X 2-1/2" Hex Bolt Gr 5 NC CZ
20224	8	3/4" X 3-1/2" Hex Bolt Gr 5 NC CZ
20562	2	1" X 3" Hex Bolt Gr 8 NC YZ
44002	1	Bracket
44831	1	Push Bracket
13515	2	Spacer, NR Pin
18887	1	Grouser Name Plate Decal - Made in USA
40405	1	Warning Decal - Torque Arm
40962	1	Warning Prop 65 Decal
16895	2	Pin Weld
42163	2	Plate
43998	1	Plate, Spacer
43999	1	Plate, Relocation
44835	1	Undercarriage, Rear
44840	1	Undercarriage, Front
20740	4	1/4" Flat Washer CZ
20747	2	3/4" Flat Washer CZ
20757	16	3/4" SAE Hardened Flat Washer - 1-1/2" OD
20580	2	1/4" Hex Nut Gr 5 NC CZ
20607	18	3/4" Hex Center Lock Nut Gr 5 NC CZ
9506	1	Grouser Dozer Metal Serial Tag
Reuse Factory	4	Reuse Factory Fastener



DWG. NO.: 44835-A

Torque Arm Installation Instructions

1. Set front hitch arms to fixed position. The front hitch arms cannot be in float with torque arm installed.
!!!The front hitch arms cannot be in float with the torque arm installed!!! Refer to tractor manufacturer's operator's manual for front hitch arms fixed position pin location.
2. Position torque arm between front hitch arms. The longest edge of plate should be closest to tractor and angled edge on bottom. See photo below for correct orientation.
3. Support torque arm and install a bolting plate with 8 - 3/4" x 3-1/2" bolts and 8 - 3/4" nuts.
4. Once bolts are all installed, push torque arm evenly towards tractor. Keep torque arm parallel to front of tractor.
5. Torque 3/4" bolts to 100 ft-lbs.
6. After first 8 hours of use, re-torque all bolts.
7. Check all fasteners regularly to ensure proper operation of equipment.

Note: Torque arm can not be installed when front PTO is in use.

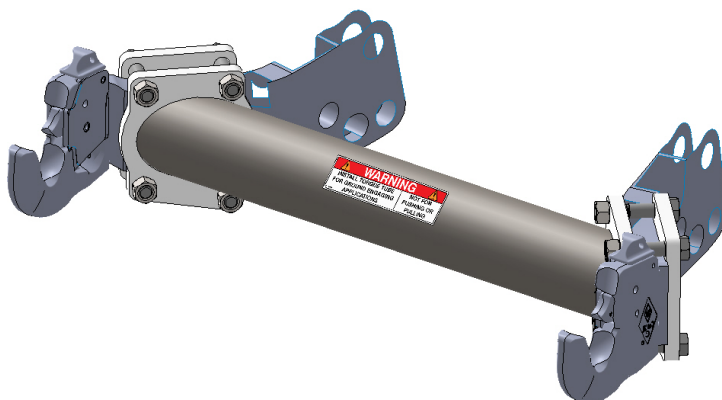

Note: The style of front hitch arms may vary slightly.



ITEM NO.	Qty.	PART NO.	DESCRIPTION
1	1	11-42165	Torque Arm
2	8	16-20224	3/4" x 3-1/2" Gr.5 Hex Bolt NC
3	1	27-40405	Warning Decal - Torque Arm
4	2	44-42163	Plate
5	8	70-20607	3/4" Center Lock Hex Nut

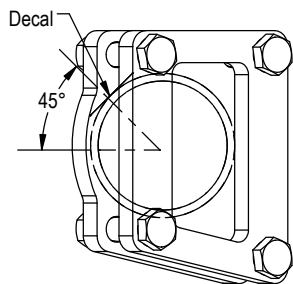
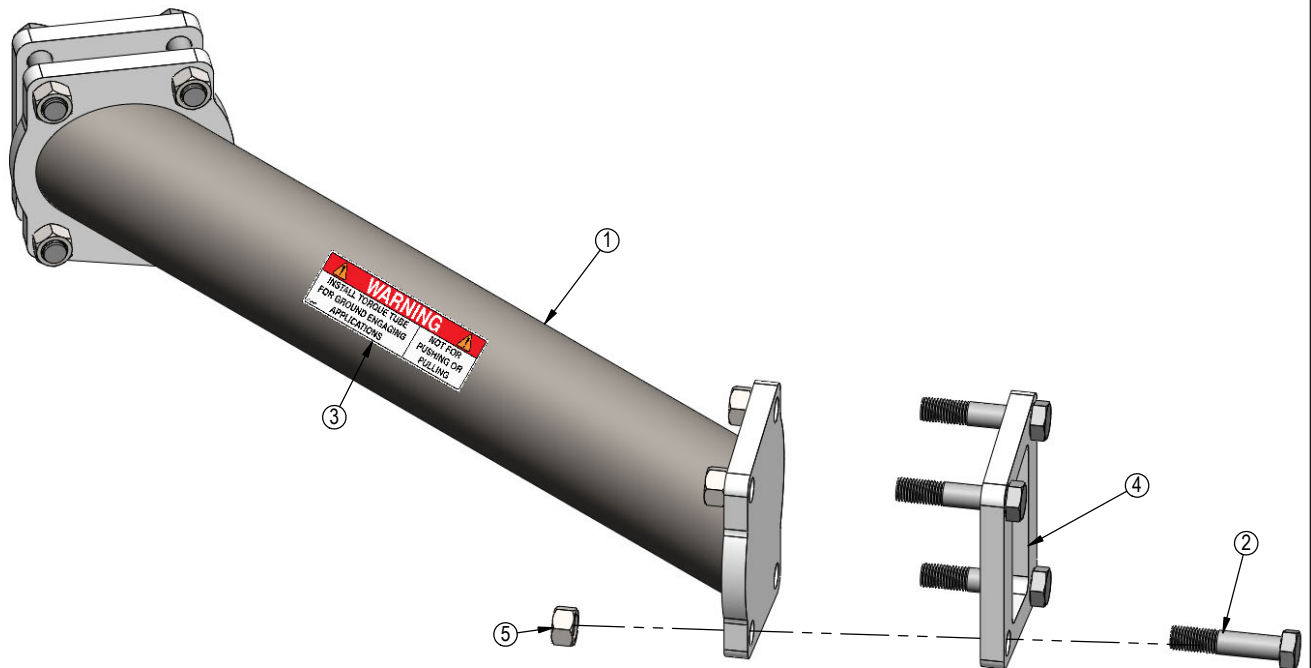

Placement of Warning Decal

Improvements

Grouser Products Inc. is continually striving to improve its products. We reserve the right to change prices, specification, or equipment at any time without notice. We also reserve the right to make improvements or changes when it becomes practical and possible to do so without incurring any obligation to make changes or additions to the equipment sold previously.

Warranty

Grouser Products warrants to the original purchaser of each item that the product be free from defects in material and workmanship under normal use and service for a period of **two (2) years for Agriculture Series Blades and one (1) year for Heavy Duty Series from date of original retail delivery.**

The obligation of the consumer under this warranty:

1. To read the operators manual and to operate, lubricate, maintain and store equipment in accordance with the instructions listed in the operators manual.
2. To inspect equipment and if any part needs repair or replacement when continued use would cause damage or wear to other parts or safety.
3. All equipment or parts claimed to be defective in material or workmanship must be made available for inspection at the place of business of a dealer authorized to handle the equipment covered by this warranty, or, upon request by Grouser Products, shipped to the Grouser Products factory in West Fargo, North Dakota.

The obligation of the dealer under this warranty:

1. Complete warranty registration form and submit within 30 days of sale.
2. Contact Grouser Products for authorization prior to performing any warranty repairs or part replacement.
3. Complete warranty request form and submit with photos and supporting documentation.

The obligation of Grouser Products under this warranty:

1. Repair or replace, any equipment or parts, in the judgment of Grouser Products to be defective in material or workmanship.
2. Grouser Products will cover the cost of parts and ground shipping at dealer invoice only.
3. Grouser Products shall have no obligation to bear the cost of labor or transportation in connection with replacement or repair of any such defective parts.

This warranty does not cover:

1. Depreciation or damage caused by normal wear, accident, improper assembly, improper adjustments.
2. Improper maintenance including lack of proper lubrication, or improper use. Including loose bolts, nuts, or fitting due to over tightening or vibration after 20 hours of operation.
3. Repairs or alterations without authorization from a Grouser Products representative.
4. Grouser Products shall have no liability if the equipment has been altered or reworked without the written authorization of Grouser Products.

Grouser Products' parts, which are furnished under this warranty and properly installed, shall be warranted to the same extent as the original parts under this warranty if, and only if, such parts are found to be defective within the original warranty period covering the original equipment.

NO EMPLOYEE OR REPRESENTATIVE OF GROUSER PRODUCTS IS AUTHORIZED TO CHANGE THE WARRANTY IN ANY WAY OR GRANT ANY OTHER WARRANTY.

Contact Us

As always, if you have any questions about your system or other products made by Grouser, feel free to contact us.



755 2nd Ave NW - West Fargo, ND 58078
+1 701-282-7710 | info@grouser.com
www.grouser.com