

Soft Track® & Hard Track Parts

Item	Model #	Description (Pads)	Tire Size	Note
2	132EX	13.25" Pad (for Soft Track® & Hard Track)	10.00	
2	147EX	14.75" Pad (for Soft Track® & Hard Track)	12.00	
2	160EX	16.00" Pad (for Hard Track)	14.00	
Item	Model #	Description (Soft Track® Shoes)	Tire Size	Note
1,2,7,9	132EXSSU	13.25" Pad & Soft Track® Insert	10.00	B
1,7	132SSU	13.25" Soft Track® Insert	10.00	
1,2,3,4,5,6,7,9	132EXSSCU	13.25" Soft Track® Pad Complete	10.00	A,B
1,2,7,9	147EXSSU	14.75" Pad & Soft Track® Insert	12.00	B
1,7	147SSU	14.75" Soft Track® Insert	12.00	
1,2,3,4,5,6,7,9	147EXSSCU	14.75" Soft Track® Pad Complete	12.00	A,B
Item	Model #	Description (Hard Track Shoes)	Tire Size	Note
1,2,8,9,10	132EXHS	13.25" Pad & Hard Track Insert	10.00	B,D
1,8,10	132HS	13.25" Hard Track Insert	10.00	D
1,2,3,4,5,6,8,9,10	132EXHSC	13.25" Hard Track Pad Complete	10.00	A,B,D
1,2,8,9,10	147EXHS	14.75" Pad & Hard Track Insert	12.00	B,D
1,8,10	147HS	14.75" Hard Track Insert	12.00	D
1,2,3,4,5,6,8,9,10	147EXHSC	14.75" Hard Track Pad Complete	12.00	A,B,D
1,2,8,9,10	160EXHS	16.00" Pad & Hard Track Insert	14.00	B,D
1,8,10	160HS	16.00" Hard Track Insert	14.00	D
1,2,3,4,5,6,8,9,10	160EXHSC	16.00" Hard Track Pad Complete	14.00	A,B,D

Note:

A. Includes 2 Links (7512), 4 Nuts, 4 Bolts, 4 Bushings (8864).

B. Includes Inserts

C. For use on F-track Only.

D. For use on Hard Tracks with replaceable shoes

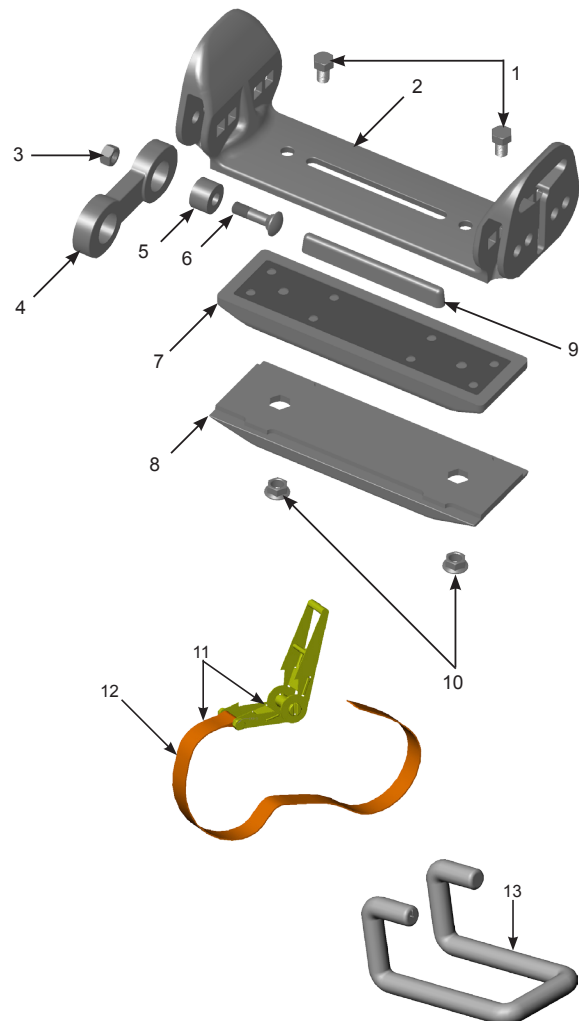
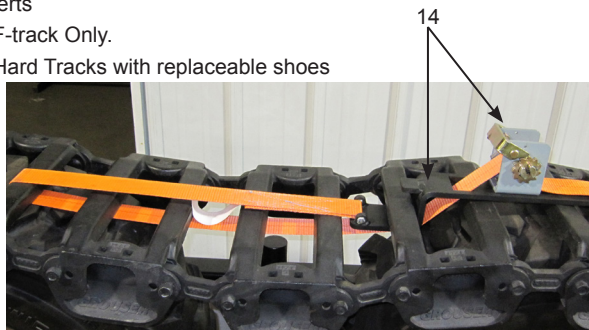

Item	Model #	Description	Note
1	3557	Hard Track Pad Bolt (1/2" x 1")	
1	3547	Soft Track® Pad Bolt (1/2" x 3/4")	
10	3548	1/2" Flange Nut	
11	1586	Standard Track Installation Tool	
12	4818	Standard Strap	
13	4824	Soft Track® & Hard Track Binder Bracket	
9	132LTB	132 Traction Bar	
9	147LTB	147 Traction Bar	
	9502	Short Traction Bar	
6	8866	C,D,E,F Carriage Bolt 1/2"x1 7/8" GR5	
3	8865	C,D,E,F Nut 1/2" NF GR5 center lock	
5	8863	D Bushing 1" (O.D.)	
5	8864	E-F Bushing 1 1/4" (O.D.)	C
4	7510	D Link (1" holes)	
4	7512	E-F Link (1 1/4" holes)	C
14	11350	Optional Track Installation Tool	